

SYSTEM SETUP

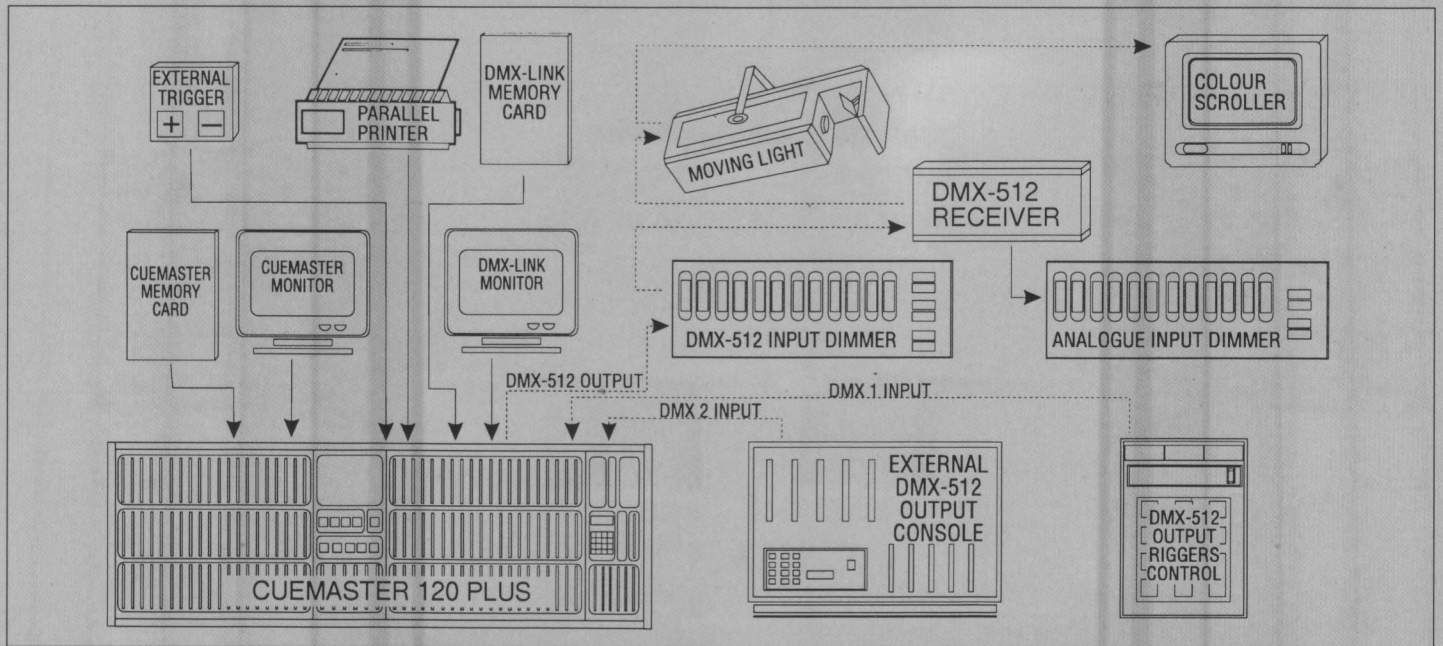

BACK PANEL LAYOUT

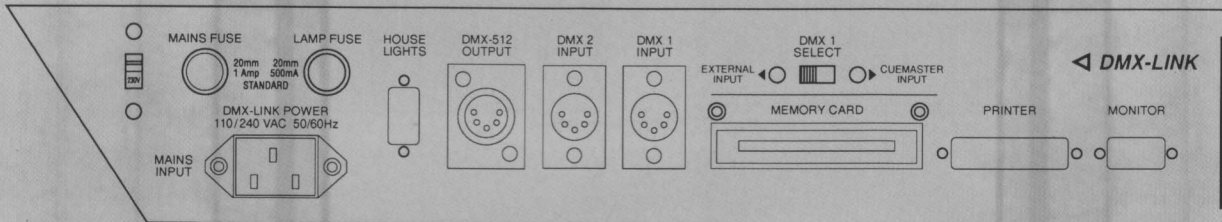
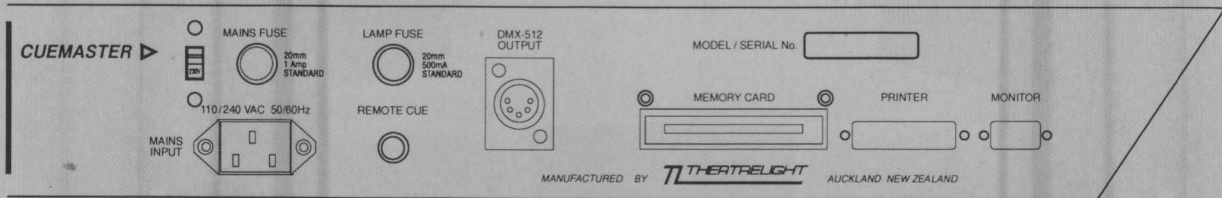

SPECIFICATIONS

CONSTRUCTION: Extruded, black anodised aluminium frame, with polished wooden ends. front panels are 2mm thick finished aluminium, anodised black with three colour screened durable epoxy ink.

FADERS: 60mm stroke linear faders with custom moulded ABS knobs. All faders are protected by a built in dust shield.

FLASHKEYS: Long-life computer key switches with custom moulded ABS caps.

POWER SUPPLY: Built in transformer to AS3108 safety standard, switchable from 110 v to 240 v.

INPUTS & OUTPUTS: USITT DMX-512 1990 Digital multiplex system.

HOUSE LIGHTS: A standard 9 pin D female socket provides Houselight fader connection for independent dimmer system.

REMOTE TRIGGER: Two channel short to earth via 6.25mm stereo jack socket.

The CueMaster and CueMaster Plus are supplied complete with a dust cover and operation manual.

OPTIONS

DYNAMIC DISPLAY: The CueMaster can be supplied with a single dynamic display and the CueMaster Plus has an option of dual dynamic displays.

PRINTER PORT: The dynamic display option also provides for printer outputs allowing cue sheets or patch lists to be printed directly to a parallel printer.

ACCESSORIES

MONITORS: Monochrome monitors capable of Hercules graphics mode are required for the dynamic display option. Theatrelight can offer a range of monitors to suit the CueMaster.

DESK LIGHTS: The Gooseneck light sockets provided with the CueMaster are fuse protected BNC sockets. Theatrelight can supply Littlite 12 inch Gooseneck lights for the CueMaster range. Bulbs are 24 volt, 2.8 watt Lucas LLB865 or equivalent.

MEMORY CARDS: Compact 32 Kbyte write-protectable memory cards with replaceable Lithium Battery with a 5 year life.

DIMENSIONS:

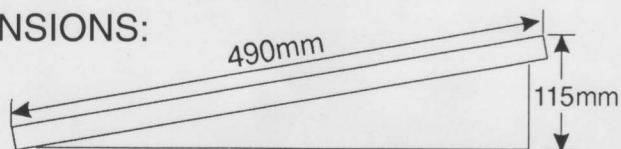

MODEL	LENGTH	WEIGHT
CUEMASTER 48	750mm	11Kg
CUEMASTER 48 PLUS	960mm	13 Kg
CUEMASTER 120	1250mm	15 Kg
CUEMASTER 120 PLUS	1440mm	17 Kg

By **THEATRELIGHT**

6 ROWE STREET, ONEHUNGA
P.O.BOX 13-159, AUCKLAND, NEW ZEALAND
TELEPHONE: 64 9 622 1187, FAX: 64 9 636 5803

YOUR AGENT: